



# Boat Guard

## An End to Boat Switch Problems

Barantech's Boat Guard marine switch is designed to solve common switching issues on boats, offering a durable and elegant alternative to mechanical pushbuttons. It features interchangeable relay modules for maximum flexibility.

Engineered to retrofit standard 22mm pushbutton cutouts with ease, Boat Guard is available in latching, momentary and timed switch functions, making it suitable for a wide range of marine control applications.

### Key Characteristics

- **Unmatched Durability:** Stainless steel housing for an ultra-rugged design.
- **Effortless Installation:** Snap-on relay module for quick setup.
- **Vivid Illumination:** Tri-color RBW (Red, Blue, White) ring illumination for captivating visual appearance.
- **Reliable and Sealed:** No moving parts, completely sealed against the elements.
- **Enhanced Touch Activation:** Operate by hand, gloves or tools with touch-activated functionality.
- **Built for the Elements:** Unaffected by water, salt accumulation, UV rays, humidity, extreme temperatures as well as shocks and vibrations.



## Electrical Data

Switch Function	Latching / Momentary / Timed
Operating Voltage	12V DC, 0.2A
Relay Rated Voltage	12V AC/DC
Relay Rated Current	20A max

## Mechanical Data

Housing Materials	Stainless Steel
Actuation Force	3-7 N
A,B Connection	Quick Connect Terminal Mates with Fast 250
Connection	22 AWG Wires, Length 300 ±20mm

## Environmental Data

Operating Temperature	-15°C to +55°C
Storage Temperature	-40°C to +75°C
IP Rating	IP67

## Electrical Connection

Manual RBW illumination:

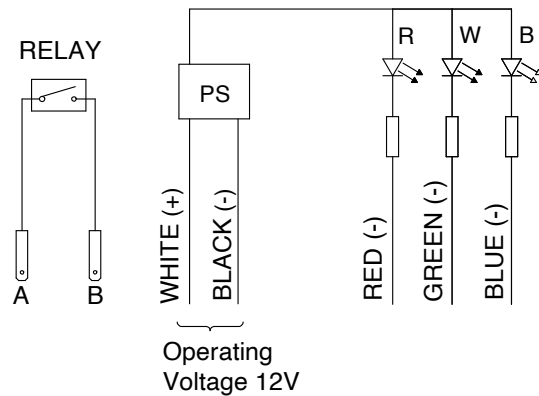

Auto internal control - two colors illumination:

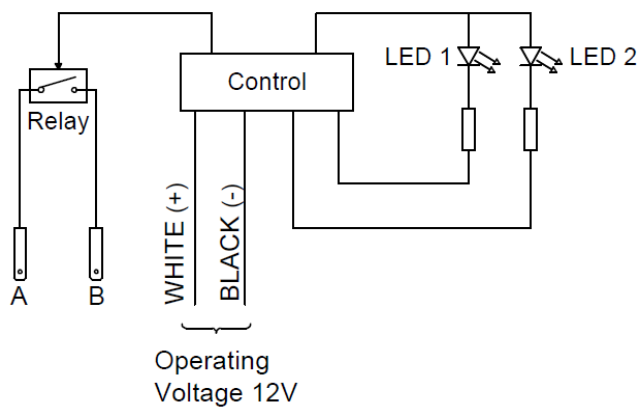

### Color Options

LED 2 - *OFF* State	LED 1 - *ON* State
RED	BLUE

## Mechanical Drawing

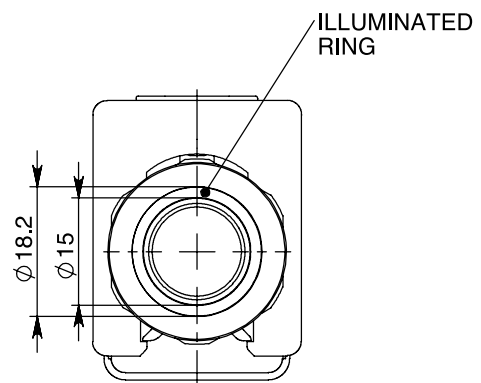
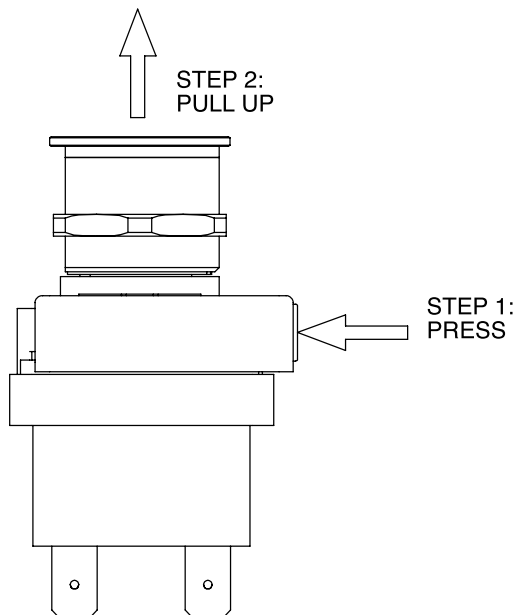
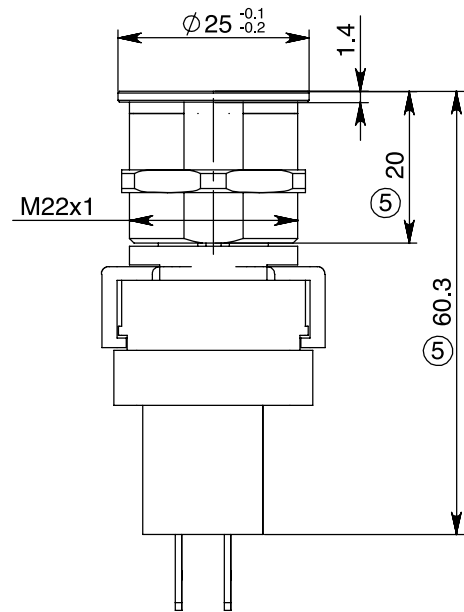
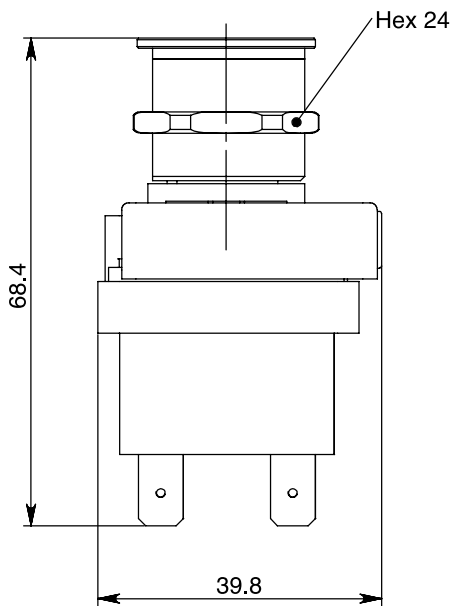

\*The specifications, descriptions and illustrations indicated in this document are based on current information. All content is subject to modifications and amendments. Users should evaluate the suitability and test each product selected for their own applications.